

MAGNAVOX

ALEXA PORTABLE SPEAKER

VOICE ACTIVATED WATER PROOF

OWNER'S MANUAL

PLEASE READ BEFORE OPERATING THIS EQUIPMENT.

MODEL: MSH317

Size: 148.5(W) x 210(H)mm (A5)

IMPORTANT SAFETY INSTRUCTIONS

FCC NOTICE:

This equipment has been tested and found to comply with the limits for a Class B digital device, pursuant to part 15 of the FCC Rules. These limits are designed to provide reasonable protection against harmful interference in a residential installation. This equipment generates, uses and can radiate radio frequency energy and, if not installed and used in accordance with the instructions, may cause harmful interference to radio communications.

However, there is no guarantee that interference will not occur in a particular installation. If this equipment does cause harmful interference to radio or television reception, which can be determined by turning the equipment off and on, the user is encouraged to try to correct the interference by one or more of the following measures:

- Reorient or relocate the receiving antenna.
- Increase the separation between the equipment and receiver.
- Connect the equipment into an outlet on a circuit different from that to which the receiver is connected.
- Consult the dealer or an experienced radio/TV technician for help.

FCC WARNING:

To assure continued compliance, follow the attached installation instructions and use only shielded cables when connecting to other devices. Modifications not authorized by the manufacturer may void user's authority to operate this device.

Location of Controls

TOP VIEW

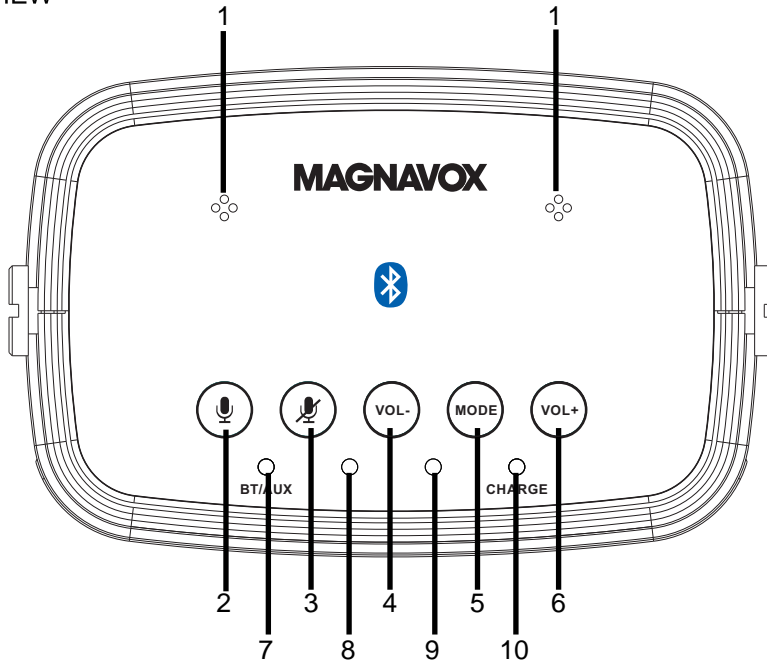

REAR VIEW

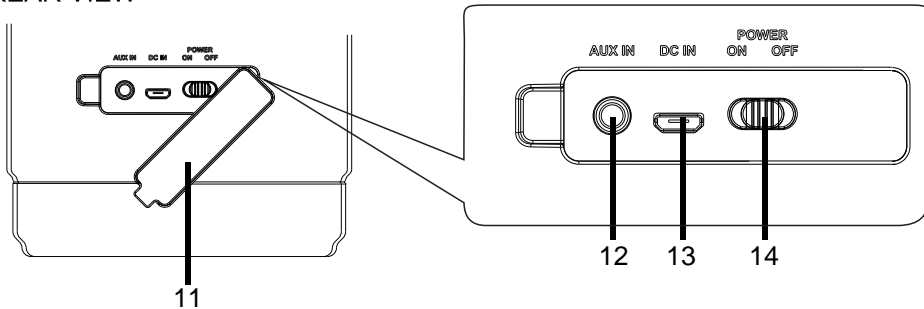

- | | |
|---|---|
| <ul style="list-style-type: none"> 1. Built-in Microphones 2. Alexa Microphone Button 3. Alexa Microphone Off Button 4. VOL- (Volume Down) Button 5. MODE Button 6. VOL+ (Volume Up) Button 7. BT/AUX (Bluetooth/Aux In) Indicator | <ul style="list-style-type: none"> 8. Alexa Indicator 9. Alexa Microphone Off Indicator 10. CHARGE Indicator 11. Rubber Cover (The cover is for Dust/water Ingress Protection, always keep it closed) 12. AUX IN Jack 13. DC IN (Micro USB) Port 14. POWER ON/OFF Switch |
|---|---|

Power Source

The unit has a built-in Li-ion rechargeable battery, charge it before first time use or when it is drained as below:

1. Open the rubber cover on the rear of unit as illustrated below:

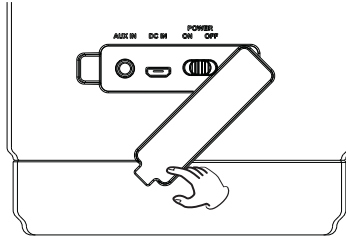

2. Connect the Micro USB Plug from the supplied USB Charging Cable to the DC IN (Micro USB) Port.
3. Connect the full size USB plug from the supplied USB Connection Cable to the USB Port on the Personal Computer or USB Charger (Computer and USB Charger not included).

To Computer or any USB Charger



To DC IN (Micro USB) Port on the rear of unit

4. While charging, the Red Charging Indicator on the top of unit will illuminate. When finished charging, it will turn off.
5. When charging, you can also play and listening music at the same time.

Notes:

Your battery will last longer if you follow these simple guidelines for caring and storing:

- A. Before first time use, charge it approximately 4 hours until the unit is fully charged.
- B. Recharge and store the unit within the temperature range of 5°C~35°C (40°F~95°F).
- C. Do not charge longer than 24 hours. Excessive charging or running the unit until the battery fully drains will damage battery. Battery life will be extended if you keep the battery fully charged.
- D. Battery life naturally shortens slowly over time.
- E. The rechargeable battery incorporated in this product is not user replaceable.

WiFi Setup

You can stream music to the unit from a mobile device on your Wifi network by using the “**MAGNAVOX BT Player**” app. To use this feature, the unit **MUST** join the same Wifi network as the mobile device:

1. Download the “**MAGNAVOX BT Player**” app from the Google Play or Apple App Store into your mobile device then install it following the on screen instructions.
2. Pair the unit to your mobile device through BT (Bluetooth) as follows:
 - Slide the POWER ON/OFF Switch on the rear of unit to ON position to power on the unit. You will hear an audible prompt say “**Power on; Bluetooth mode; waiting for connection**”. The **BT/AUX** Indicator on the top of unit will illuminate and blink.
 - Power on the external Bluetooth Device and enter the Bluetooth search mode. Start pairing following the on screen instructions from the external Bluetooth Device. When paired, the unit will sound an audible prompt “**Bluetooth connected**” and the **BT/AUX** Indicator will stop blinking.

Notes:

- When the mobile device searched the unit, our model number “**MSH317_XXX**” will appear on the display of mobile device. (XXX is the identify number of the exciting unit).
 - If while pairing you are asked for a code please try “0000” or “1234”.
3. Open the “**MAGNAVOX BT Player**” app on your mobile device. Wait a few seconds, the follows screens will appear on your mobile device one by one:

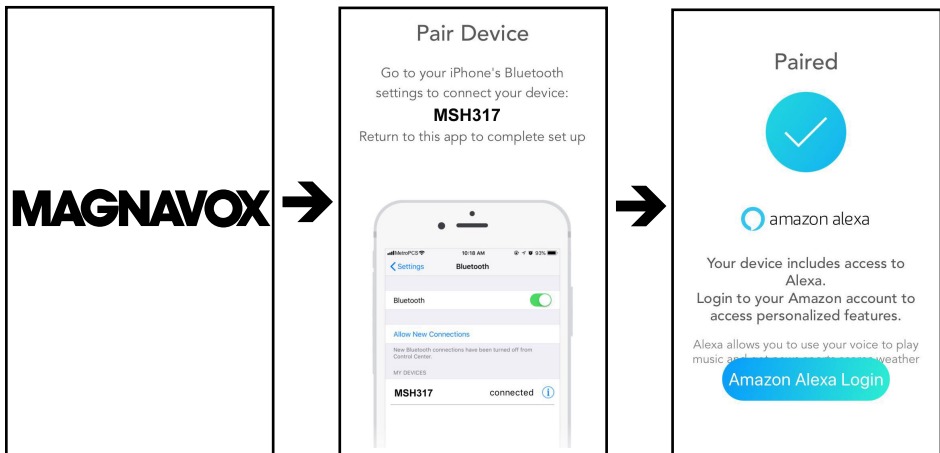

4. Tap/touch the “**Amazon Alexa Login**” Button on the screen. The following screen will appear on your mobile device.

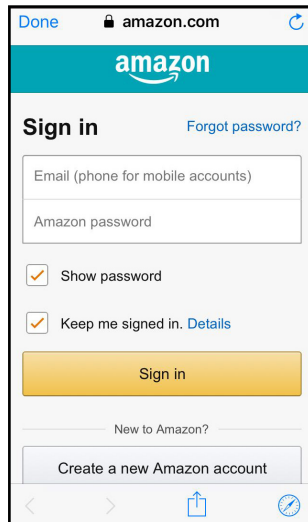

5. Sign in or create an Amazon account follows the on screen instructions. When signed in, the following screen may appear on your mobile device:

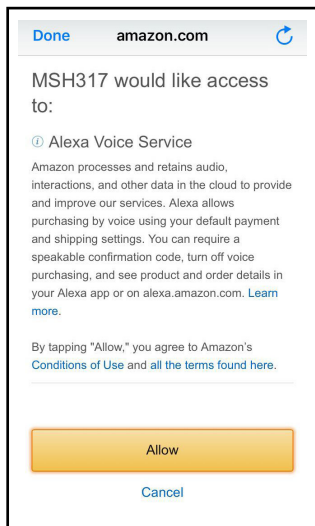

6. Tap/touch the “**Allow**” Button on the screen to continue.

7. The following screen will appear, select and set the region you are in, then touch “Next” Button to continue.

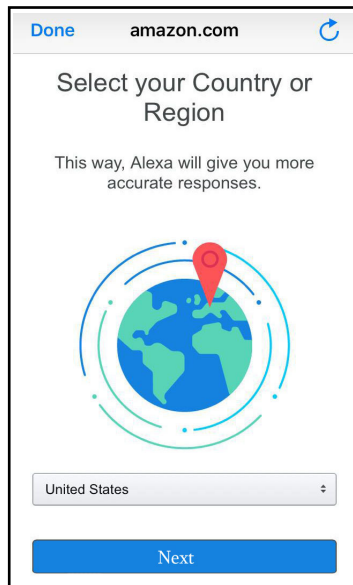

8. When the following screen appear, touch the “Done” Button on it to complete settings.

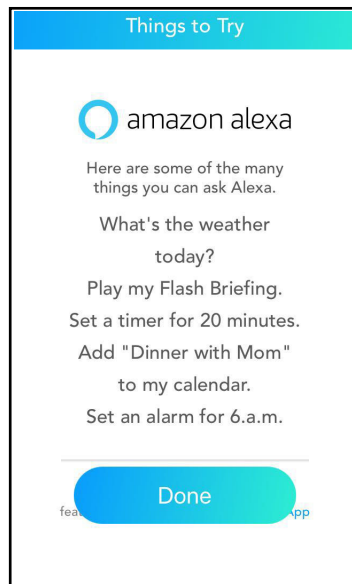



Operation

Music playback and Alexa:

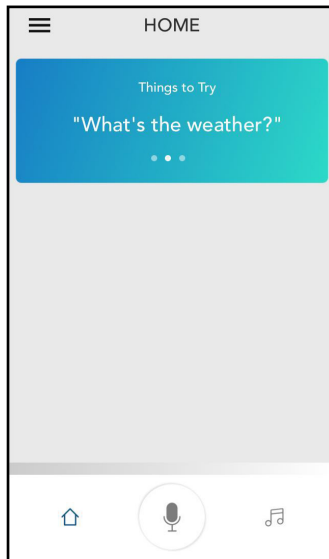
1. Connect the unit to your Wifi network as previously instructed.
2. Recharge the built-in Li-ion battery as previously instructed.
3. Paired the unit to your mobile device.
4. Power on the external BT Device and enter to BT mode.
5. Slide the POWER ON/OFF Switch on the rear of unit to ON position to power on the unit. You will hear an audible say “**Power on; Bluetooth mode; waiting for connection**”. The **BT/AUX** Indicator on the top of unit will illuminate and blink.
6. Wait a few seconds until the unit is automatically paired to the mobile device. The unit will sound a prompt “**Bluetooth connected**” and the **BT/AUX** Indicator will stop blinking.
7. After pairing is complete you may now play music and answer calls with your mobile device. During playback:
 - Using the controls on the paired mobile device to pause; skip tracks as usual.
 - Press the **VOL +/-** buttons to adjust volume level as desired.
8. Play music or ask questions with **Alexa**:
 - Open the “**MAGNAVOX BT Player**” app in your mobile device. Wait a few seconds until the following screen appears on your mobile device:





- Say “**Alexa**” to the microphone or press the “” Alexa Microphone Button on unit, the Alexa Indicator on the top of unit will illuminate. Ask your questions or instructions to the microphone on the top of unit. (Or press the “” Microphone Button on the mobile device, then speak your questions or instructions to the microphone on the mobile device).

Wait for the reply from Alexa. Examples of Voice Commands when speaking to Alexa:

- (Alexa) Who are you?
- (Alexa) What's the time now?
- (Alexa) What's the news today?
- (Alexa) Play the song.
- (Alexa) Stop (or Pause) the song.
- ETC.

9. When the unit is paired to a Cell Phone:

- If a call is incoming during an active music session:
 - Press any button on the top of unit then speak to the Microphone to answer the call. When your call is complete, press any button to disconnect or end the call and resume to music playback.
 - Press and hold the “” Alexa Microphone Off Button approximately 1 second to decline the incoming phone call then resume to music playback.

10. To avoid activating Alexa by accident, press and hold the “” Alexa Microphone Off Button until the color of the **Alexa** Indicator and **Microphone** Indicator turn red to signal the microphone is turned off. Press and hold to turn on again.

11. When finished, slide the **POWER ON/OFF** Switch to OFF position to shut off the unit. You will hear an audible prompt say “**Power off**”.

AUX IN:

Listen to music from an external Audio Player such as an MP3 Player, Discman ETC:

1. In power off mode, connect one end of the Audio Connection Cable (not included) to the AUX Out / Line Out / Phone Jack on the external Audio Player.
2. Connect the other end of the cable to the “**AUX IN**” Jack on the rear of the unit.

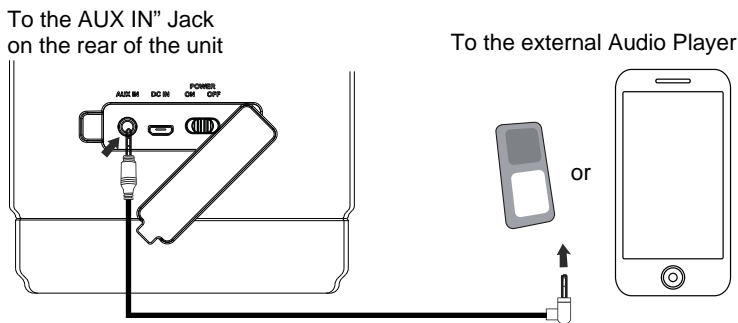

3. In power on mode, press the “**MODE**” Button to turn to AUX IN mode. The color of the BT/AUX Indicator will turn to Green. You will also hear an audible say “**AUX IN**”.
4. Play the music on the connected Player as usual. (Make sure the volume level of the connected Audio Player is turned to high level.)
5. Press the **VOL +/-** buttons to adjust volume level as desired.
6. When finished, slide the **POWER ON/OFF** Switch to OFF position to shut off the unit. You will hear an audible say “**Power off**”.

Cleaning



1. To prevent fire or shock hazard, disconnect your unit from the AC wall outlet when cleaning.
2. The finish on your unit may be cleaned with a dust cloth and cared for as other furniture.
Use caution when cleaning and wiping the plastic parts.
3. Mild soap and a damp cloth may be used.

Troubleshooting Guide

Check the following before requesting service:

SYMPTOM	POSSIBLE CAUSE	POSSIBLE SOLUTION
Can't power on	Built in battery drained	Recharge the battery
No sound or sound weak	Volume level in minimum position	Rise the volume level by press the VOL+ Button on the top of unit
	Volume level of paired/connected device is in low level	Rise the volume level of the paired/connected device
Sound distortion	Volume level too high	Reduce the volume level by press the VOL- Button on the top of unit
	Volume level of the connected/paired device too high	Reduce the volume level of the connected/paired device
BT not functioning	The external BT device had NOT paired to the unit	Pair the external BT device to the unit as page 5
	The external BT device too far from the unit	Place the external BT device close to the unit
Wi-Fi not functioning	The unit had NOT add in the Wi-Fi network and/or had NOT sign in Amazon account	Add the unit into the Wifi network and sign in Amazon account as page 5-7
Alexa not functioning	The unit is not in the Amazon Alexa operation mode	Install and open the " Alexa BT Player " in your mobile device

General Specifications

Power source: Built-in DC  3.7V, 1800mAh (6.66WH) rechargeable Li-ion Battery,
Recharge by DC  5V through DC IN (Micro USB) Port

BT Version:	4.1
BT Operation Distance:	Up to 32 Feet in open area
Dust/water Ingress Protection Level:	IP44

Accessories

- 1 x Owner's Manual
- 1 x USB Charging Cable
- 1 x Audio Connection Cables with 3.5mm Stereo Plugs

**SPECIFICATIONS AND ACCESSORIES ARE SUBJECT TO CHANGE
WITHOUT NOTICE**

LIMITED WARRANTY

Craig Electronics warrants this product to be free from manufacturing defects in material and workmanship under normal use for a period of 180 days from date of purchase. If service is required, please return the product to the store where it was purchased for exchange; or, pack the unit in the original packing material with all accessories if applicable, a copy of your sales receipt and a Cashier's check or Money Order for \$12 (to cover shipping and handling costs) payable to Craig Electronics Inc. For consumers in Canada, please make sure that the cashier check or money order is redeemable through a U.S. bank. Ship your product freight pre-paid. Your unit will be repaired, replaced or if the unit cannot be repaired or replaced, a refund will be forwarded to you within four weeks of receipt of your unit. Please ship your unit to:

Craig Electronics Inc.
1160 NW 163 Drive
Miami, FL 33269

This warranty is void if the product has been: a) Used in a commercial application or rental. b) Damaged through misuse, negligence, or abuse. c) Modified or repaired by anyone other than an authorized Craig service center. d) Damaged because it is improperly connected to any other equipment.

Note: This warranty does not cover: a) Ordinary adjustments as outlined in the Owner's Manual which can be performed by the customer. b) Damage to equipment not properly connected to the product. c) Any cost incurred in shipping the product for repair. d) Damage to the product not used in the USA.

This warranty is not transferable and only applies to the original purchase. Any implied warranties, including the warranty of merchantability, are limited in duration to the period of this expressed warranty and no warranty whether expressed or implied shall apply to the product thereafter.

Under no circumstance shall Craig be liable for any loss or consequential damage arising out of the use of this product. This warranty gives specific legal rights. However, you may have other rights which may vary from state to state. Some states do not allow limitations on implied warranties or exclusion of consequential damage. Therefore, these restrictions may not apply to you.

This product has been manufactured by and is sold under the responsibility of Craig Electronics Inc, and Craig Electronics Inc is the warrantor in relation to this product. MAGNAVOX and SMART. VERY SMART are registered trademarks of Koninklijke Philips N.V. and are used under license from Koninklijke Philips N.V.

To Obtain Service on your Product
email: magnavox@craigelectronics.com